

**CC06-HB23F****2 Mega Pixel Stainless Steel Bullet****Features**

1 / 2.8" 2MP Sony STARVIS image sensor
 Full HD 1080P @ 30 Frame Per Second
 HD-AHD, HD-TVI, HD-CVI, & CVBS
 FIXED 2.3MM Wide View Lens
 Waterproof / IP68 Compliant (AISI 316L)

More Features

1 / 2.8 Sony STRAVIS

2 Megapixel 1080P

30 FPS Real time

HD-AHD, HD-TVI, HD-CVI, CVBS

D-WDR (Digital WDR)

DC 12V Power

AISI316L Body and Bracket

3D DNR

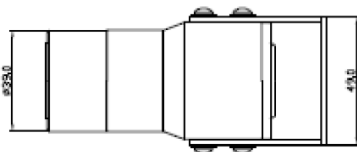
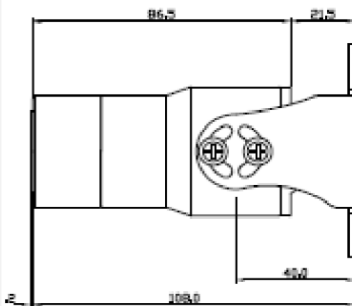

Specification	CC06-HB23F
Mode Format	NTSC / PAL
Image Sensor	1 / 2.8" Sony STARVIS CMOS image sensor
Active Pixel	1920 (H) x 1080 (V)
Resolution	1080P @30 fps / 1080P @25fps
Min. Illumination	Color : 1.0 lux, Color DSS: 0.002 lux
Scanning System	Progressive
Video Output	Signal Mode AHD, CVI, TVI :1080p & Analog: NTSC /PAL CVBS
S/N Ratio	More than 50dB (AGC off)
AGC	Off / 0-15
Shutter Speed	AUTO / MANUAL (1/50 (60) – 1/50,000 sec)
SENS-UP	Off / x2 – x30
Brightness	0-100
Backlight	Off / BLC / HSBLC
D-WDR	Off / 0-8
Defog	Off / Auto
Day & Night	AUTO / Color B&W / EXTERN
White Balance	ATW / AWC / INDOOR / OUTDOOR / Manual / AWB
DNR	Off / Low / Middle / High
Mirror	Off / MIRROR / V-FLIP / ROTATE
Sharpness	0-10 steps
Privacy Mask	4 Masks
Motion Detection	Off / On
Language	English, Chinese, Germany, French, Italian, Spanish, Polish Russian, Portuguese, Dutch, Turkish, Korean Japanese
Power Source	DC 12v
Power Consumption	Max 4.0 Watt AT
Operating Temp.	-20C to 60C /
Operating Humidity	10% to 85%
Lens	2.3mm Megapixel Lens
Dimension	39mm x 109mm (L) / 1.53in x 4.29in (L)
Weight	Approx. 610 G / 1.34 Lbs