



CC06-HB36F

Stainless Steel Bullet Camera



Features

- 1 / 2.8" 2MP Sony STARVIS sensor
- Full HD Mega Pixel 1080P @ 30fps
- HD-AHD, TVI, CVI CVBS (single mode)
- Fixed 3.6mm Megapixel Lens
- Stainless Steel AISI 316L rated
- IP-68 compliant / Waterproof

More Features

- 2 Megapixel @ 30fps Full Real-Time
- Max Resolution 1920 x 1080
- DC 12V Power
- IP 67 protection AISI 316L

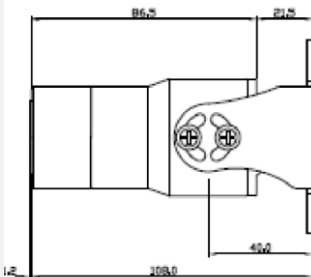

Specification	C006-HB36F
Image Sensor	1 / 2.8" Sony STARVIS CMOS Image Sensor
Active Pixel	1920 x 1080
Resolution	1080P @30fps / 1080P @25fps
Min. Illumination	Color: 1.0 lux, Color DSS: 0.002 lux
Scanning System	Progressive
Video Output	AHD, CVI or TVI :@ 1080P / Analog : NTSC/PAL CVBS
S/N Ratio	More than 50dB (AGC off)
AGC	Off / 0-15
Shutter Speed	AUTO /MANUAL (1/50(60) – 1/50,000 sec)
SENS-UP	Off / X2 – X30
Brightness	0 – 100
Backlight	Off / BLC / HSBLC
D-WDR	Off / 0 – 80
Defog	Off / AUTO
Day & Night	AUTO /Color / B & W / EXTERN
White Balance	ATW /AWC /INDOOR / OUTDOOR / Manual / awb
DNR	Off / Low / Middle / High
Mirror	Off / MIRROR / V-FLIP /ROTATE
Sharpness	0 – 10 Steps
Privacy Mask	4 Masks
Motion Detection	Off / On
Language	English / Chinese / Germany / French / Italian / Spanish / Polish / Russian / Portuguese / Dutch / Turkish / Korean / Japanese
Power Source	DC12V
Power Consumption	Max 4.0 Watt at
Operating Temperature	-20C to 60C / -4F to 140F
Operating Humidity	10% to 85%
Lens	3.6mm Megapixel Lens
Dimension	39mm x 109mm (L) / 1.53in x 4.29in (L)
Weight	Approx. 610g / 1.34Lbs