

USER'S MANUAL

TVI 2.0 Stainless Steel Auto Focus IR Bullet Camera

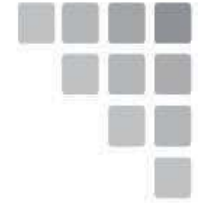

CAUTION

RISK OF ELECTRIC SHOCK
DO NOT OPEN

CAUTION : TO REDUCE THE RISK OF ELECTRIC SHOCK,
DO NOT REMOVE COVER
NOT USER SERVICEABLE PARTS INSIDE
REFER SERVICING TO QUALIFIED SERVICE PERSONNEL

Dimensions

Part name & Dimension

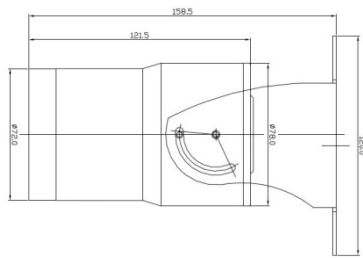

Installation

Step.1

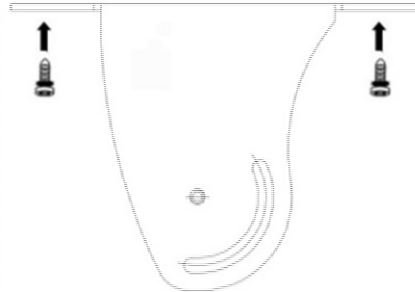

Fixing bracket at desired place

Features

- 1/3" Panasonic CMOS image sensor
- Full HD Mega Pixel (1080P)
- Auto Compensation & Long range transmission
- Excellent Low illumination performance
- 2 pcs Pearl LEDs
- 2.8~12mm DC auto iris motorized megapixel lens
- True Day & Night with ICR Mechanism
- 3D DNR (Digital Noise Reduction)/ SENS-UP
- D-WDR (Digital Wide Dynamic Range)
- External Zoom & Focus Adjustable
- 3 axis concealed bracket
- Weather proof / IP-68 rating
- DC12V

Specifications

Image Sensor	1/3" Panasonic CMOS image sensor
Resolution	1080P
Scanning System	Progressive
Video Output	TVI: 1080P, 720P Analog: NTSC/ PAL CVBS
S/N Ratio	More than 50dB (AGC off)
Min. Illumination	Color : 1.0 lux, BW : 0.5 lux, Color DSS : 0.002 lux, BW DSS : 0.0008 lux
D-WDR	Off/0~8
SENS-UP	Off/X2 - X30
Backlight	Off/BLC/HSBLC
DNR	Off/Low/Middle/High
Privacy Mask	4 Masks
Motion Detection	Off/On
Power Source	DC12V ±10%
Power Consumption	Max 2.0 Watt
Operating Temperature	-10°C to 50°C
Operating Humidity	10% to 85%
Lens	2.8~12mm DC auto iris MP lens (ICR)
Dimension/mm	Φ76 X 158.5(W) X 120(H)
Weight/g	920

Accessories

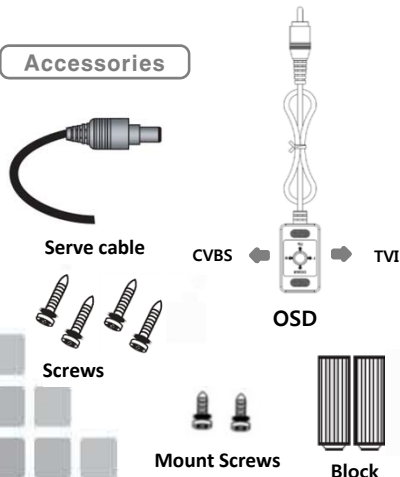

Cable

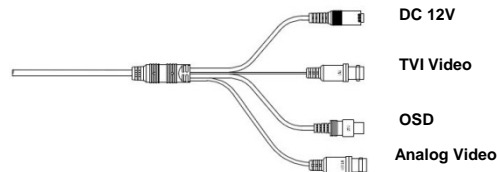

CAUTION! Please use regulated power supply DC12V 500mA
Reverse Polarity Protection

All specification and pictures are subject to change without notice to improve quality.