



FIRMWARE Update Instructions

(Make sure to read the disclosure first)

Please call or email for support with any questions before moving forward.

tech@opticomtech.com or 800-578-1853

How to identify the camera chipset:

By going into the home screen of the camera or checking with the IP Installer.

In The firmware `*.**-**rp_OC` or `*.**-**ra_OC` or `*.**-**rc_OC`

Sample; showing is a rp_ chipset. Our latest firmware will only work rp_ firmware version. Please call if you have a different chipset that you would like to upgrade. 800-578-1853



| Model | MAC address | IP address | IP Type | Server name | HTTP port | Version | Status |
|-------------|--------------|-----------------|---------|-------------|-----------|---------------|--------|
| CC04-IP3MV3 | 00306F4A90D6 | 192.168.116.124 | DHCP | IP System | 80 | 4.64-B4-rp_OC | Succes |

Total : Searching... Found : Searching... Timeout : Searching... AdminID : root

Opticom Technologies Inc. www.opticomtech.com

Please, wait for a while. (It depends on your network condition.)

HW Mod  32 %

Firmware ver : 4.64-B4-rp_OC

How to confirm if firmware will work with your camera

- Firmware will list
 - Model
 - Chipset
 - Version
-
- If your chipset doesn't match your camera's firmware, don't update it
 - If your version is the same or newer version you don't need to update it.

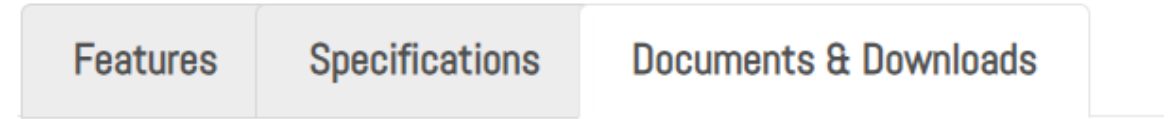

- CC04-IP3MV – Spec sheet
- CC04 Quick set up Manual
- CC04 Users Manual
- IP-Installer-V3.12.0
- **CC04-FIRMWARE-rp_4.64**
- FIRMWARE Disclaimer -READ FIRST
- Firmware Update intruction
- Microsoft Edge guide

rp_chipset

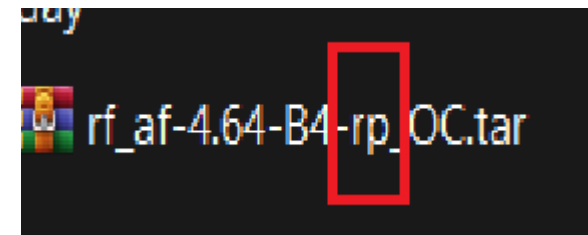

Confirm the Model and Chipset

Note: Be sure that the firmware you have downloaded is a later version than the one currently installed

The screenshot displays the Opticom Viewer Software interface. At the top, there are navigation buttons for HOME, LIVE, and ADMIN. Below these is a banner for "OPTICOM Industrial Network Cameras Viewer Software". The main area shows a camera image and a "Full Remote" control. A window titled "IP Installer (v3.11.0)" is overlaid, displaying a table of camera details. The table has columns for Model, MAC address, IP address, IP Type, Server name, HTTP port, Version, and Status. The first row shows Model: CC04-IP3MV3, MAC address: 00306F4A90D6, IP address: 192.168.116.124, IP Type: DHCP, Server name: IP System, HTTP port: 80, Version: 4.61-057-rp_OC, and Status: Success. A red box highlights the Model and Version columns. A red arrow points from the text "rp - chipset" to the Version field. Below the IP Installer window, the text "Video Cameras" is visible. At the bottom of the interface, there is a footer with "Opticom Technologies Inc." and "www.opticomtech.com". A small window at the bottom center shows "Model : CC04-IP3MV3" and "Firmware ver : 4.61-057-rp_OC", with a red box around it and a red arrow pointing from the text "RP - Chipset" to the firmware version.

| Model | MAC address | IP address | IP Type | Server name | HTTP... | Version | Status |
|-------------|--------------|-----------------|---------|-------------|---------|----------------|---------|
| CC04-IP3MV3 | 00306F4A90D6 | 192.168.116.124 | DHCP | IP System | 80 | 4.61-057-rp_OC | Success |

Total : 1 Found : 1 Timeout : 0 AdminID : root

Opticom Technologies Inc. www.opticomtech.com

Model : CC04-IP3MV3
Firmware ver : 4.61-057-rp_OC

Make sure to download and read the disclaimer first to avoid VOIDING WARRANTY

PART NO. CC04-IP3MV
Category Industrial Cameras



Features

Specifications

Documents & Downloads

- CC04-IP3MV – Spec sheet
- CC04 Quick set up Manual
- CC04 Users Manual
- IP-Installer-V3.12.0
- CC04-FIRMWARE-rp_4.64
- **FIRMWARE Disclaimer -READ FIRST**
- Microsoft Edge guide

Firmware upgrades are progressive. You will need to upgrade each version in between your currently installed version and the latest version offered.

Which means that after you confirm your current version, then update to the next version in line before updated to the latest. (call with questions)

PART NO. CC04-IP3MV
Category Industrial Cameras

Features

Specifications

Documents & Downloads

- CC04-IP3MV – Spec sheet
- CC04 Quick set up Manual
- CC04 Users Manual
- IP-Installer-V3.12.0
- **CC04-FIRMWARE-rp_4.64**
- FIRMWARE Disclaimer -READ FIRST
- Microsoft Edge guide

Make sure
download is
complete by
checking you
download
folder

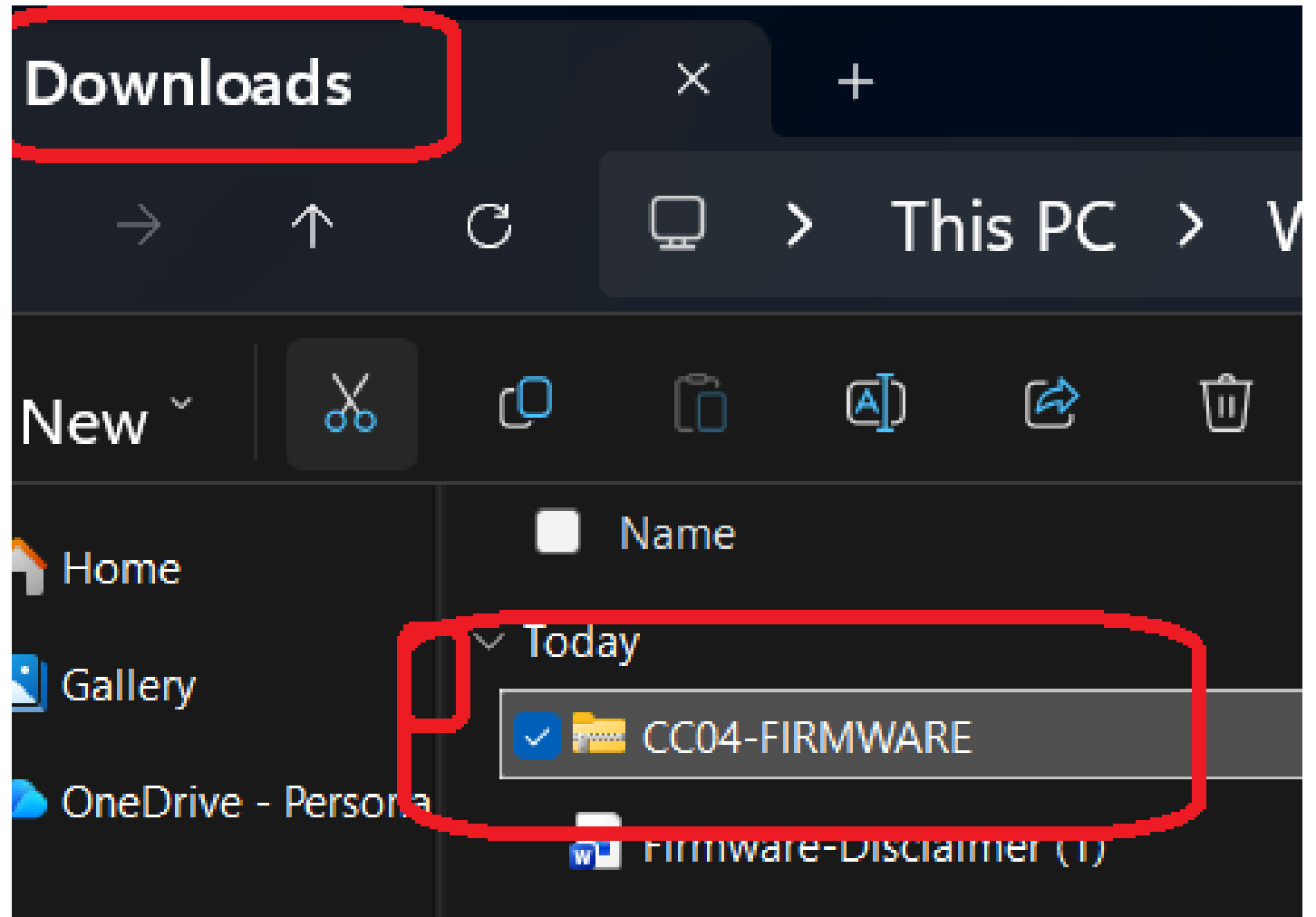

Make sure to extract the firmware once the download is completed

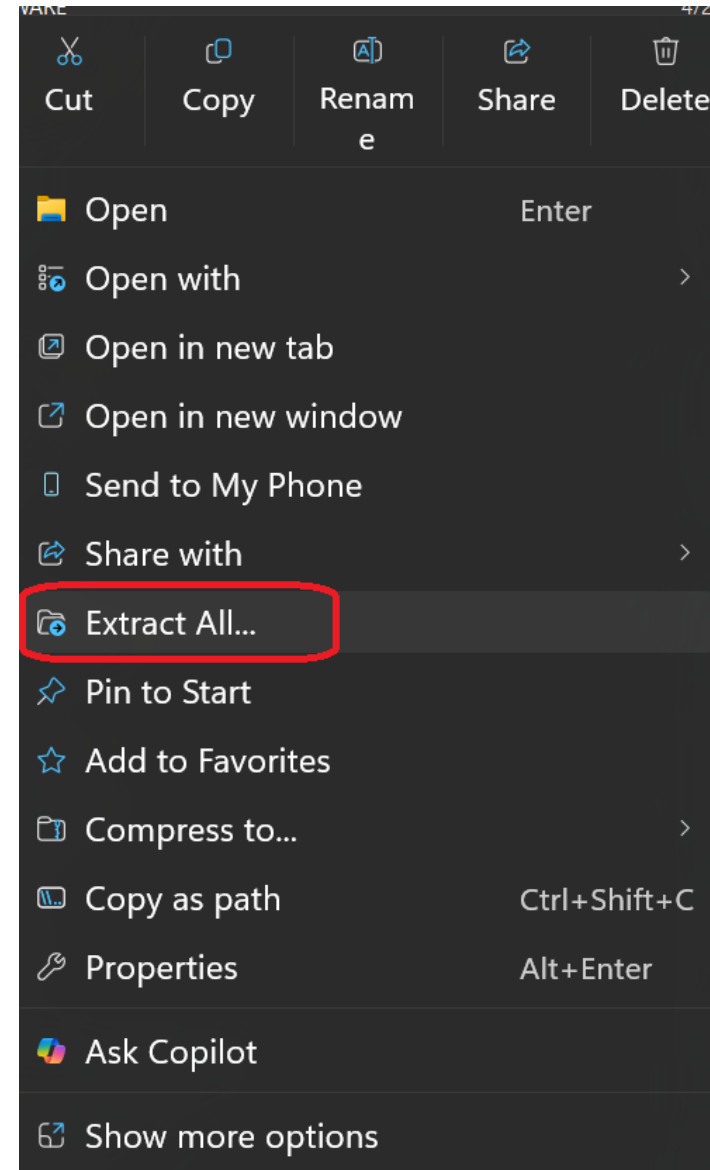



Downloads



CC04-FIRMWARE



Sort



View



Name

Date modified

Type

Today



rf_af-4.64-B4-rp_OC.tar

4/29/2026 8:36 AM

Win

Log into
camera and
select
(ADMIN)

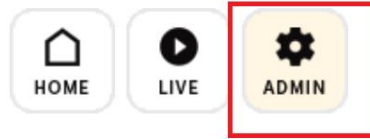

Full Remote
Access via
Web Browser

Rugged IP
Video Cameras



Opticom Technologies Inc.

www.opticomtech.com

Model : CC04-IP3MV3
Firmware ver : 4.61-057-rp_OC



Enter you login information

Sign in to access this site

Authorization required by http://192.168.116.124
Your connection to this site is not secure

Username

Password

Select Utilities

then

Select Update



- [-] Network
- [-] System
- [-] Video & Audio
- [-] Device
- [-] Advanced
- [-] **Utilities** 1.
 - » Log
 - » Reboot
 - » Restore Default
 - » **Update** 2.

| | |
|---------------------------------------|---|
| Video with Flexible Extra System data | <input checked="" type="checkbox"/> Enable |
| Video with user defined message | <input type="checkbox"/> Enable |
| Video with PPP status | <input type="checkbox"/> Enable |
| Video with camera name | <input type="checkbox"/> Enable |
| Video with server name | <input type="checkbox"/> Enable |
| Video with IP address | <input type="checkbox"/> Enable |
| Time Stamp | Off ▾ |
| TV Out | <input checked="" type="radio"/> Enable <input type="radio"/> Disable |
| Audio Codec | G.711 μ-LAW ▾ |

Primary | **Secondary** | **Tertiary**

| | | |
|-------------------|---|---------|
| Camera Name | Primary Stream | |
| Frame Rate | 30 fps | ▾ |
| Image Size | 2048 x 1536 | ▾ |
| Encoding Standard | H.264 | ▾ |
| H.264 Profile | <input type="radio"/> Main <input checked="" type="radio"/> High | |
| Rate Control Mode | CBR Mode | ▾ |
| Target Bitrate | 5.0 Mbps | ▾ |
| GOP Structure | 60 | [1~100] |
| Audio | <input type="radio"/> Enable <input checked="" type="radio"/> Disable | |

Make sure you have confirmed the camera chipset, (sample is the (rp_)

Then Click on Start

Update

| | |
|-----------------------------|--------------------------------------|
| Firmware Update | <input type="button" value="Start"/> |
| PTZ Device Driver Update | <input type="button" value="Start"/> |
| Sensor Device Driver Update | <input type="button" value="Start"/> |

| System Information | |
|--------------------|------------------------|
| Mac Address (S/N) | 00:30:6F:4A:90:D6 |
| Firmware version | 4.61-057-rp_ <u>OC</u> |

Select OK, to continue process

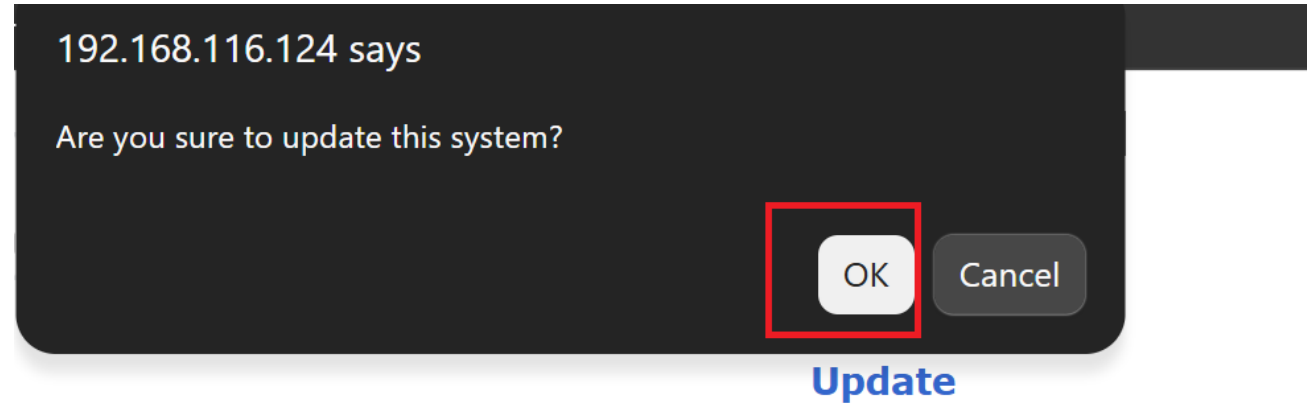

| | |
|-----------------------------|-------|
| Firmware Update | Start |
| PTZ Device Driver Update | Start |
| Sensor Device Driver Update | Start |

| System Information | |
|--------------------|-------------------|
| Mac Address (S/N) | 00:30:6F:4A:90:D6 |
| Firmware version | 4.61-057-rp_OC |

Select (Choose File)

Please upload " **rf_af*.tar.gz** " file for Firmware.
For the system safety, "**Do not close this window compulsory.**"

Select file : No file chosen

Description

Processing : 0 %

Look in downloads or wherever you saved the firmware and select the firmware
Then click Open

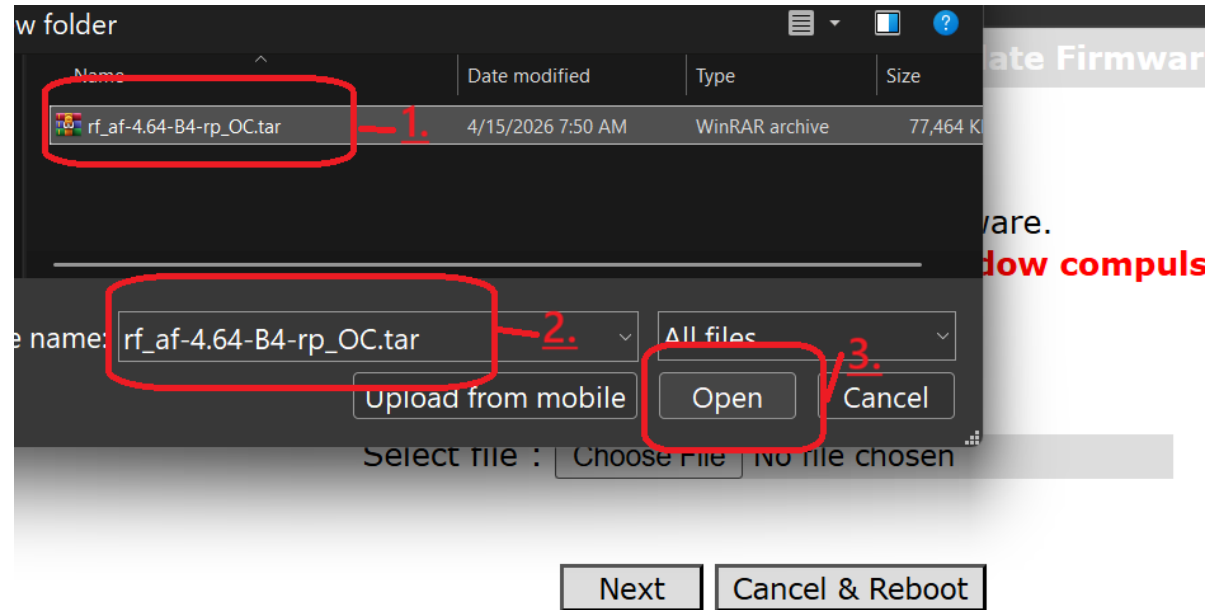

Description

Processing : 0 %

Click on “Next” after confirming the correct file has been selected

Please upload " **rf_af*.tar.gz** " file for Firmware.
For the system safety, "**Do not close this window compulsory.**"

The screenshot shows a web interface for uploading a firmware file. A red box highlights the file selection area, which includes a 'Choose File' button and a text input field containing the filename 'rf_af-4.64-B4-rp_OC.tar.gz'. Below this, another red box highlights the 'Next' button, with a red arrow pointing to it from the number '1.'. A third red arrow points from the number '2.' to the 'Description' section, which displays 'Processing : 0 %'. The 'Cancel & Reboot' button is also visible to the right of the 'Next' button.

Select file :

Description

Processing : 0 %

Please upload " **rf_af*.tar.gz** " file for Firmware.
For the system safety, "**Do not close this window compulsory.**"

Select file : rf_af-4.64-B4-rp_OC.tar.gz

Description

Processing : 2 %

File rf_af-4.64-B4-rp_OC.tar.gz is 12 percent uploaded

Click Next

Please click "Next" and wait for a while.
(It will take a few seconds.)
After procedure is completed, you will go to the next step.

If you click "Cancel", this system will reboot.
For the system safety, "**Do not close this window compulsory.**"

| File Information | |
|-------------------------|----------------------------|
| File Name | rf_af-4.64-B4-rp_OC.tar.gz |
| File Size | 77463 KB |

Previous

Next

Cancel & Reboot

Description

Processing : 20 %

Processing post firmware-update.

Please wait for a while.



Description

Processing : 31 %

Click on Reboot

This command will reset this system. All connections will be disconnected and Network Video System can not monitor your site within several seconds.

You should reboot this system.

Reboot!!

Description

Processing : 40 %
Change BOOTMODE ... DONE

Processing post firmware-update.

Please wait for a while.



Description

Processing : 40 %
Change BOOTMODE ... DONE

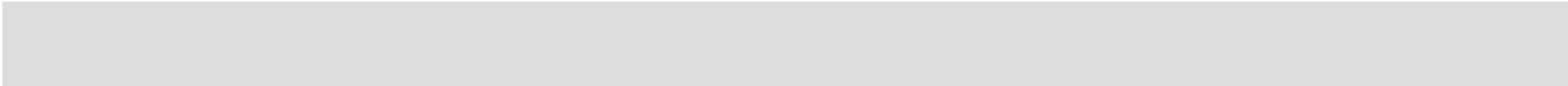

Firmware upgrade has done.
Please close the webpage
And connect again.

Confirm
firmware
version has
been updated

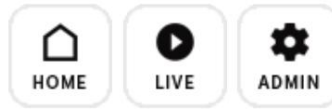

OPTICOM Industrial Network Cameras
Viewer Software

Full Remote



| Model | MAC address | IP address | IP Type | Server name | HTTP port | Version | Status |
|-------------|--------------|-----------------|---------|-------------|-----------|---------------|---------|
| CC04-IP3MV3 | 00306F4A90D6 | 192.168.116.124 | DHCP | IP System | 80 | 4.64-B4-rp_OC | Success |

Total : 1 Found : 1 Timeout : 0 AdminID : root

Opticom Technologies Inc. www.opticomtech.com

HW Model : CC04-IP3MV3
Firmware ver : 4.64-B4-rp_OC





After confirm update was
done correctly.

New log in information is:

Username: admin

Password:123456